

Want to be part of the largest triathlon training squad in Melbourne? Don't train with a triathlon squad or club but want the benefits of doing so? If you're thinking that now is the perfect time to get in touch with like-minded people, be connected whilst training towards a common goal and have a place to meet, mingle and keep your belongings on race day, then we have the answer.

Tri-Alliance has released its Annual Triathlon Membership, so you can gain all the benefits of being part of our squad.

Annual Membership

For just \$99 annually, you'll all these great benefits:

- Welcome pack full of Tri-Alliance goodies
- 20% Discounts on 2XU event registrations and other selected race discounts
- 20% discount off ON Running shoes through the Tri Shop
- 20% discount from Orca for Orca wetsuits
- 15% discounts at Giant Ormond for Giant and LIV bikes, product and apparel
- 10% off Garmin devices and accessories via our TriShop
- 10-20% Discounts on Tacx Indoor Trainers via our TriShop
- 10% discount at Lakeside Sports Medicine Centre
- Cheapest Prices in Australia for KODA Nutrition via our TriShop
- Discounts on social events, camps and training gear
- Discounts on Tri Alliance Services – Retul Bike fit, Altitude Training, Coaching Consultations and more
- Exclusive access to partner discounts and specials
- Use of our athlete marquee on race day – find out what it's like to hang out with our athletes! Receive a free massage, BBQ, and access to our warm-up & cool down area!
- Receive our weekly members newsletter including training advice, tips and all things triathlon related
- Access to members only content on our website including articles, videos and training & racing information.



How to Get Signed Up?

If you are new to Tri-Alliance, head to <https://tri-alliance.com/> and create an account by selecting Register:

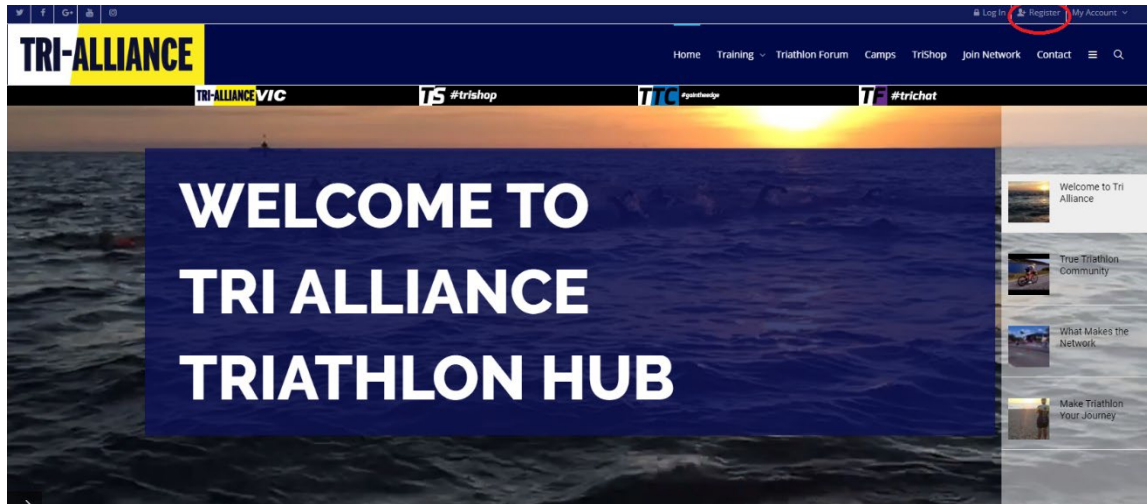

If you have previously signed up for membership, Try-The-Tri or a Tips and Tricks clinic in the past, you will have created a Tri-Alliance account, so you can select Log in and use your original email details:

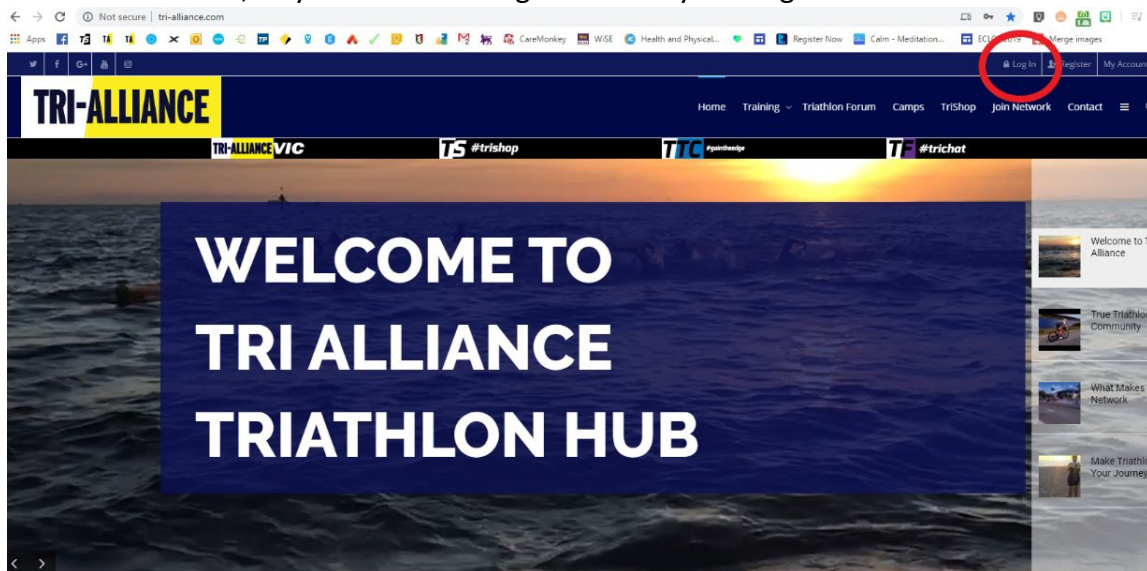

You can select Lost Your Password if your email address has been used previously:

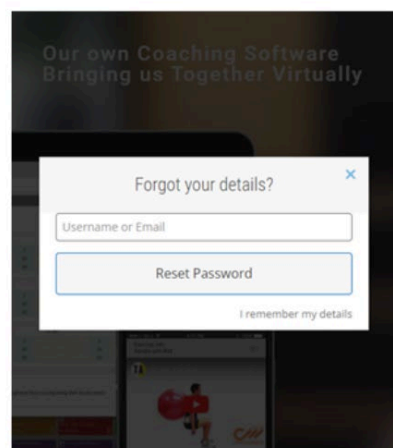
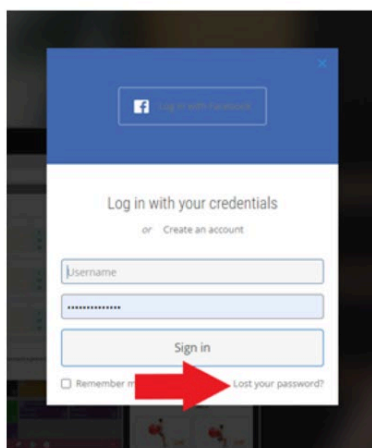
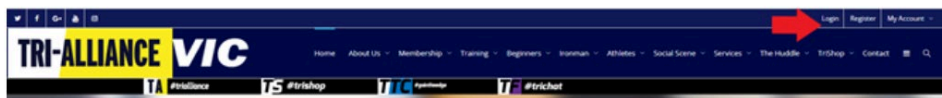

To access your membership options, please go to the PROFILE area in your Tri Alliance dashboard. If you've used our site before, you will have already created an account, so login with your original details. Use the drop-down menu in the top right-hand corner to find "PROFILE".

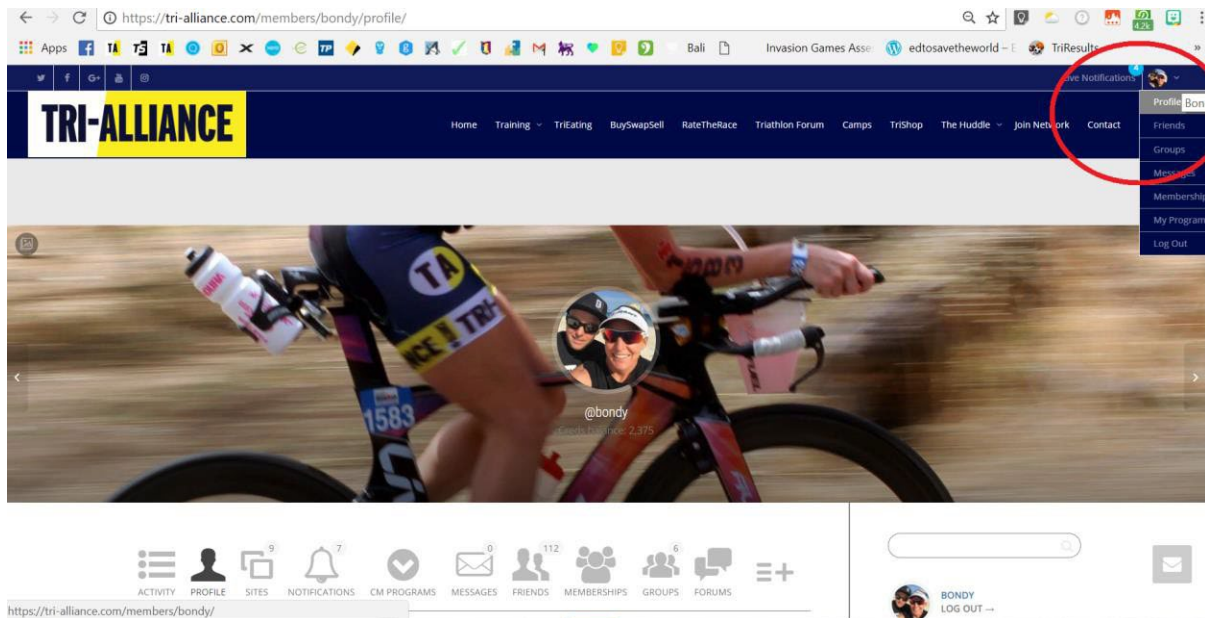

Once in your dashboard, select "MEMBERSHIPS"

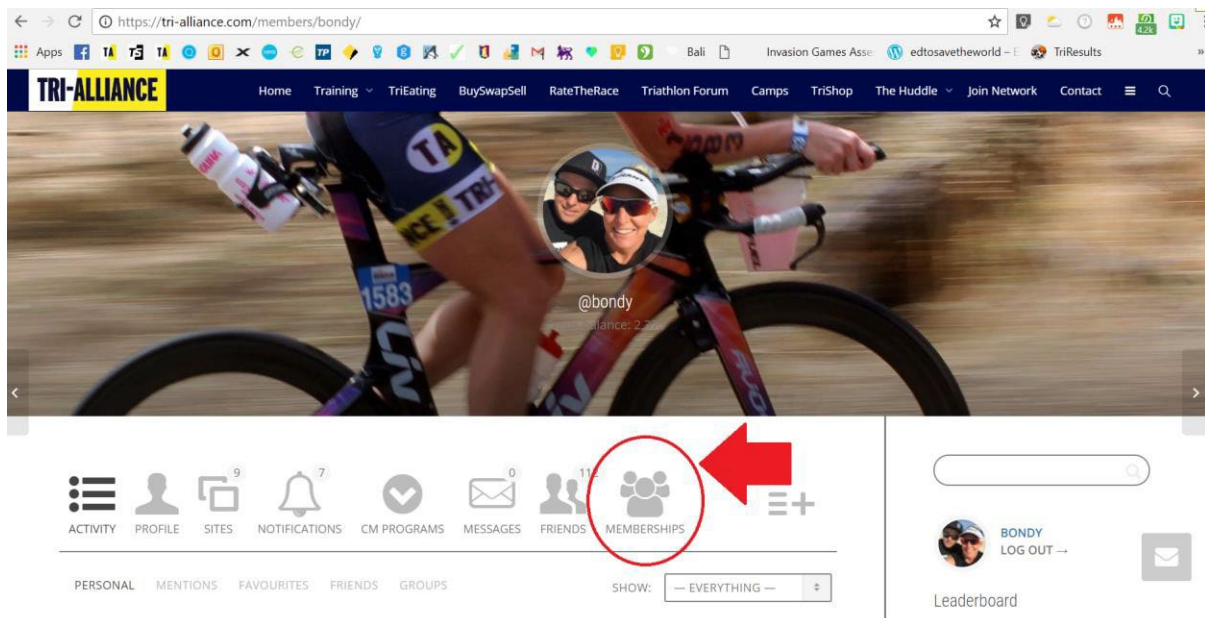

This will bring up a list of all membership options available to you.

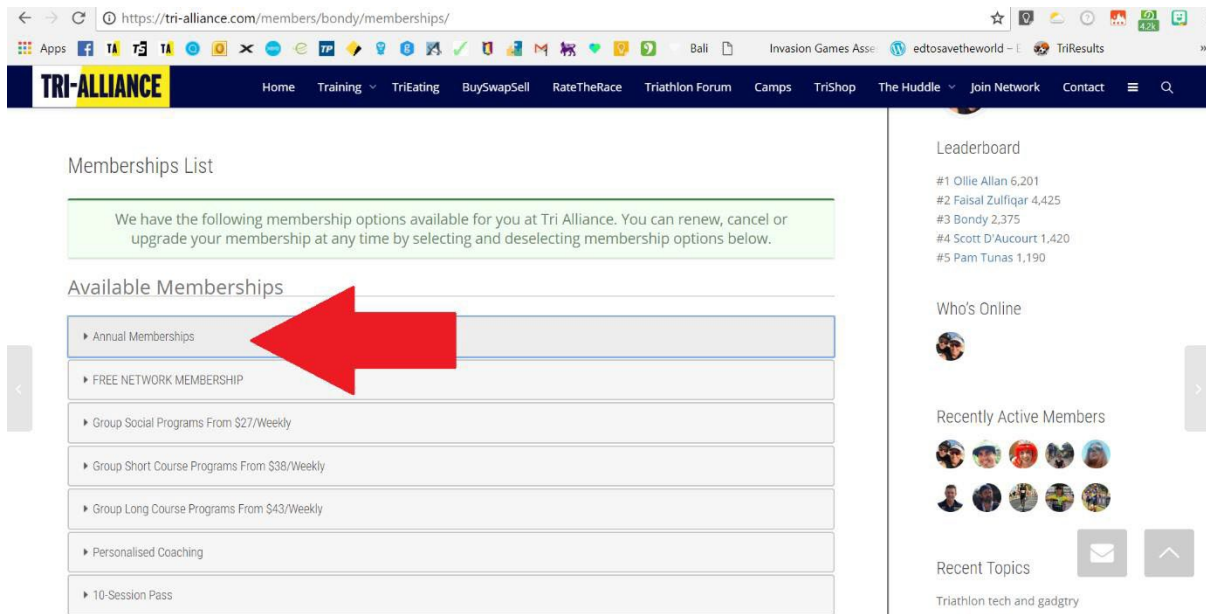

Under Annual Membership, select Signup

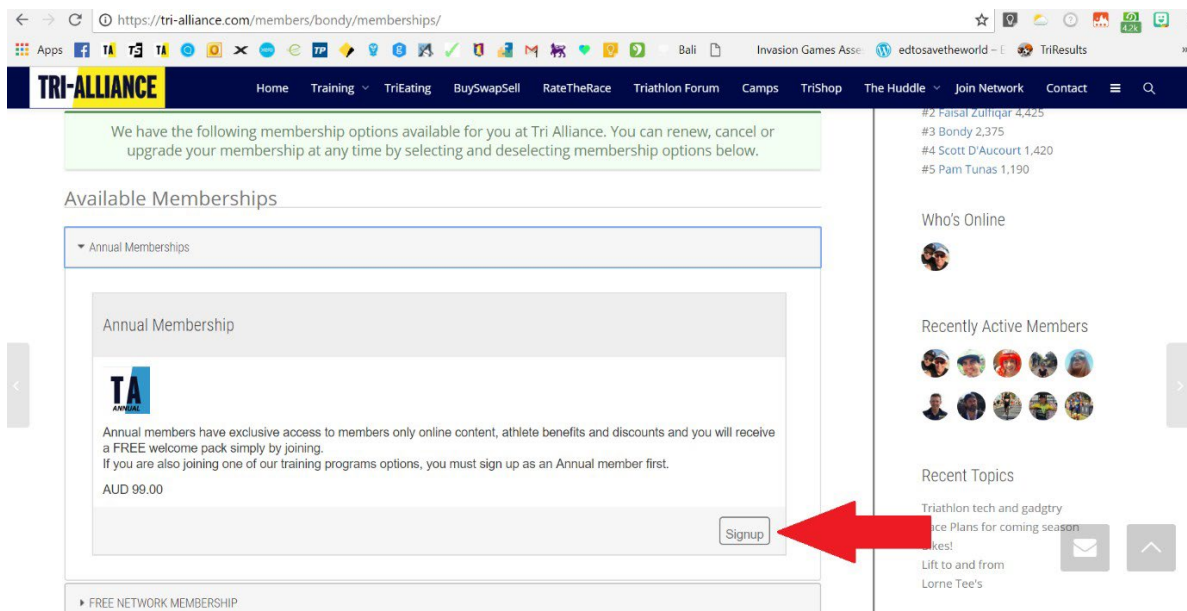

It's that easy. We'll be notified at our end, and it starts immediately. This also means that you are in complete control of your membership options. So, if you would like to add a training membership, change your payment method, cancel or renew at any time, you just follow the instructions above to log in and take care of it yourself. It's all there for you, under your PROFILE:

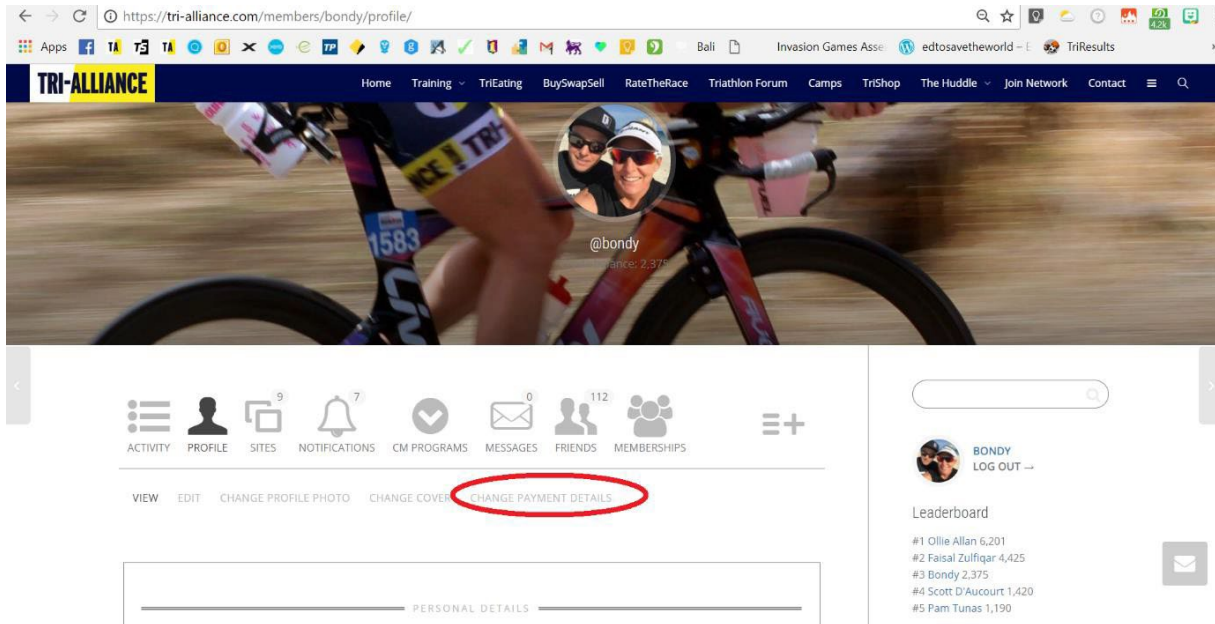

We look forward to helping you on your triathlon journey. We are here if you need anything, so always feel free to reach out to us!

Ollie & Michelle

Team Tri-Alliance

Ph: 1300 680 874

E: info@tri-alliance.com.au

Web: www.tri-alliance.com.au

